

Thank you kindly for your support.

Visit tafee.com full operating manual and guides.

Visit the website for customer service or call **1 8 HI MY TAFEE**

Mon - Fri, 11am – 4pm EST

Email info@tafee.com for support.

WARRANTY

Tafée™ guarantees to you that if used for its intended purpose the Bowle® will be free from defects in material or workmanship caused by the manufacturing process for the warranty period of two years.

This warranty does not cover accessories or device parts exposed to normal use, such as the Mouthpiece, Drinkware, Stem, Ceramic Oven Pots and Herb Shredder.

To activate your warranty, please register your product at tafee.com.

USER PRECAUTIONS

Major changes in the environment (external conditions) may cause the Bowle® to malfunction.

Always protect the Puck against liquids, rain or humidity, and high temperatures, including direct sunlight.

 Handle with care Ceramic Oven Pots are hot surfaces that can exceed 50°C.

tafee™

BOWLE QUICK START GUIDE



1 | BOWLE OVERVIEW

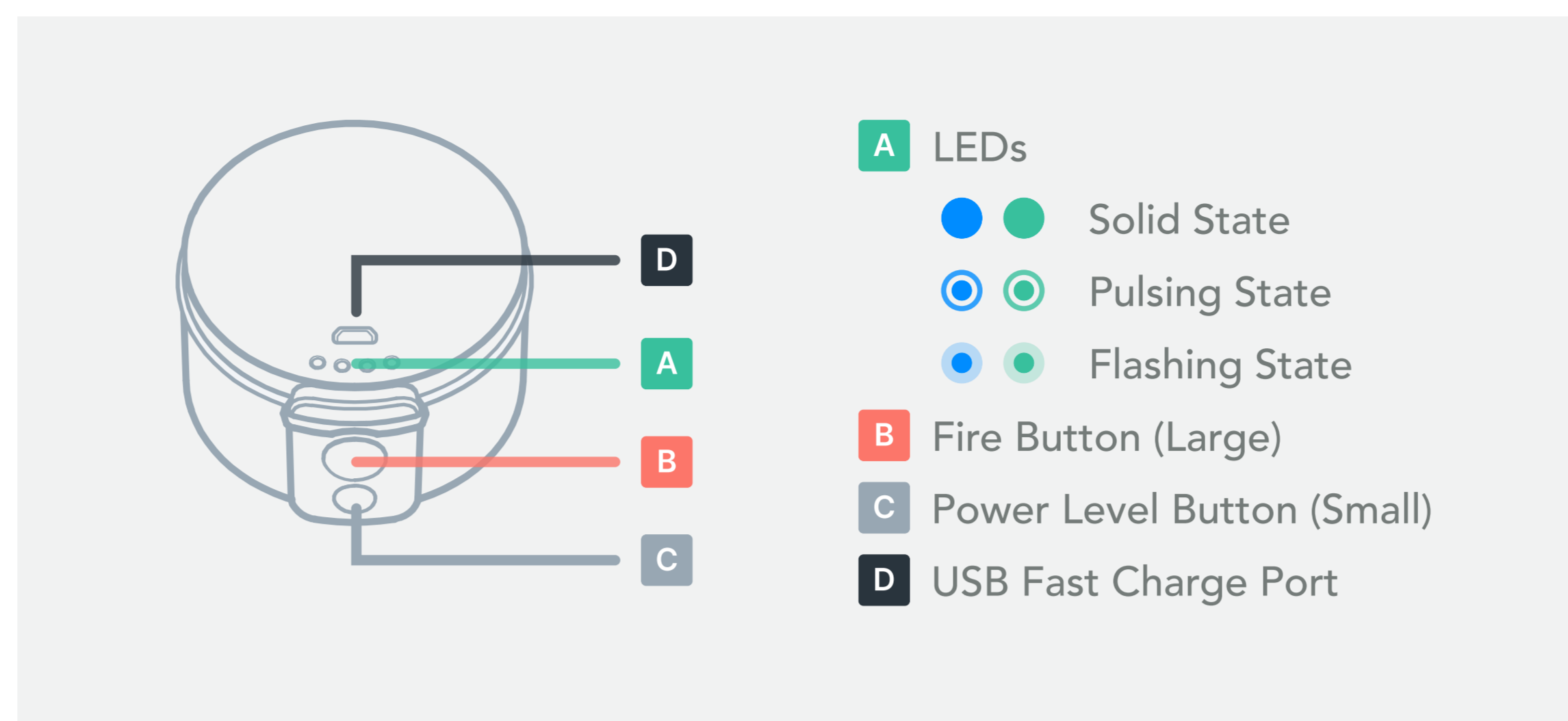

Lock/Unlock :: Click **B** 3 times (quickly).

Start (Unlocked) :: Click **B**

Change Power Level :: Click **C** to cycle.

Check Battery :: Hold and release **B** + **C**

POWER & CHARGING

■ Bowle must be charged before first use.

■ The battery charging level is indicated with blue LEDs.



■ A fully charged battery is indicated with all blue LEDs flashing simultaneously and switching off when plugged in to charge.

■ Only charge Bowle with the supplied cable and charger.

2 | BOWLE USER & METHOD

1 Cycle power to desired level with **C** Power Level Button.



2 Click and release **B** the large Fire button.
Once the oven is up to power, the LEDs will turn solid green.

3 Begin inhalation immediately from mouthpiece as soon as LEDs turn solid green (smooth and long, steady inhalation recommended).



ALTERNATE POWER USE METHOD: BETTER BATTERY LIFE AND USER CONTROL

After cycling to desired power level with the **C** Power Level button, click and hold down the **B** large Fire button.

Once the LEDs turn green, begin inhalation while continuing to hold down the **B** large fire button.

Release the Fire button once single inhalation is complete.

Inhale with a similar pace and effort of a large drinking straw.

Tafée recommends 6 seconds of steady inhalation.

3 | LOADING BOWLE WITH POTTER

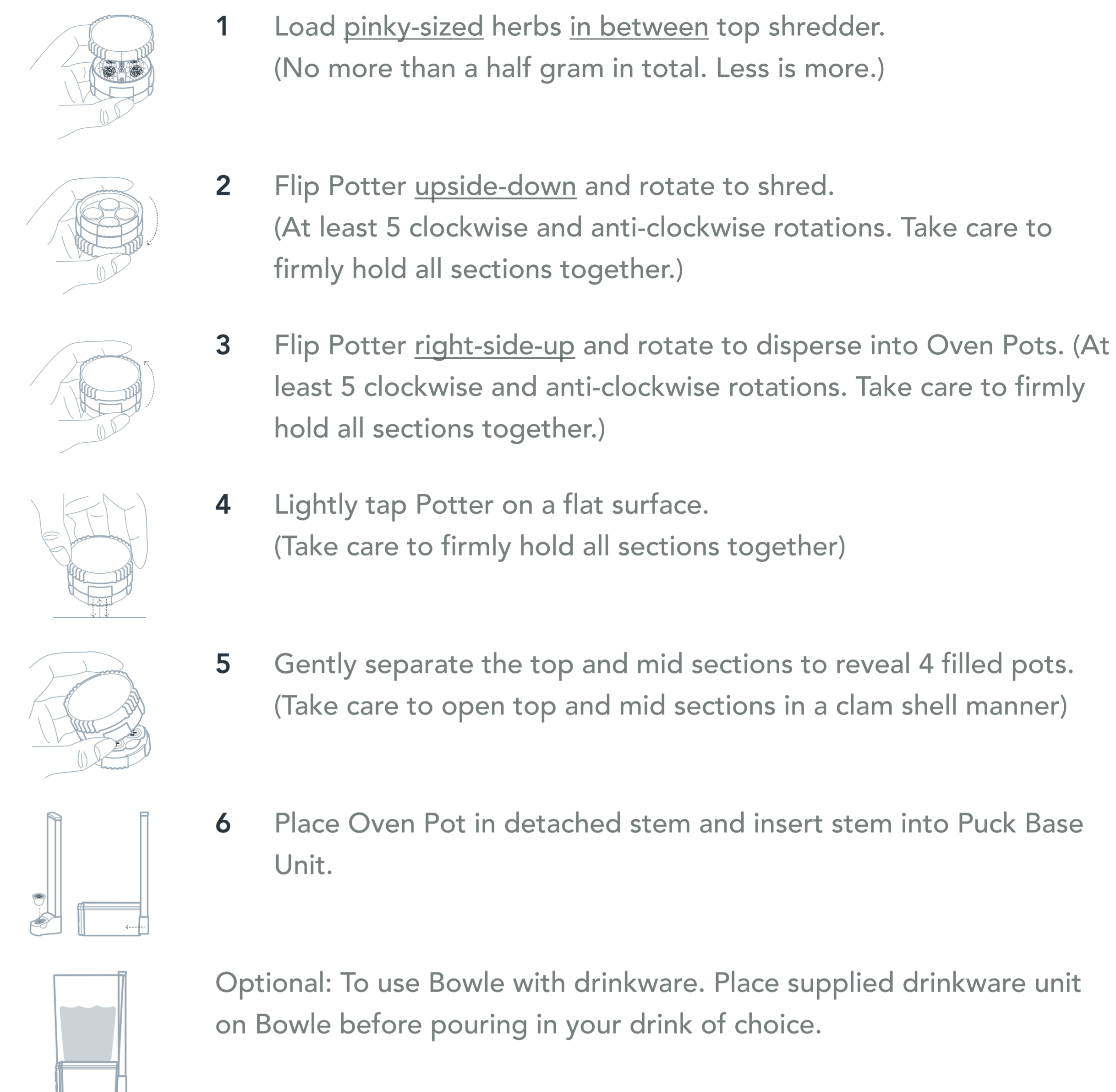

Do not clean or soak Potter or the Drinkware with any isopropyl. See care and maintenance guide and manual.

4 | DETACHING BOWLE STEM AND OPTIONAL DRINKWARE



5 | SUSTAINABLE TOLERANCE USAGE GUIDELINE

- 1 Try to have no more than 3 sessions a day.
- 2 Endeavor to remain within lower power settings and slowly work your way up.
- 3 Avoid consumption of alcoholic beverages during aromatherapy.
- 4 Take breaks and stop use during periods of any cardio-vascular health illness or discomfort. Ensure your source of aromatherapy natural herbs is trustworthy.
- 5 Take note of and avoid organic compounds and natural substances that may cause irritation.
- 6 Never overfill Ceramic Pots past 75% capacity and endeavour to empty Ceramic Pots immediately after every session to keep cleaner longer.
- 7 Charge Bowle after every second session and endeavour to avoid completely depleting your batteries.
- 8 Never touch or interact with the screen shielding the oven outlet in the puck base unit stem slot! Doing so will cause malfunction.

The device parts and accessories may require an external hygienic maintenance with extended use. Adhere to this cleaning guide to care and maintain your Bowle and accessories.

CLEANING THE PUCK BASE UNIT

The Puck Base Unit is a low maintenance design. Only basic cleaning with a clean soft fiber cloth for maintenance is required, and this is based upon the frequency of use.

Before cleaning the Puck Base Unit, disconnect the charger from the socket. The Puck Base Unit and the charger should only be cleaned externally with a dry or very lightly damp cloth and must be wiped dry afterwards.

⚠ Never touch or interact with the oven screen or silicone ring inside/above the Puck Base Unit Stem Slot. Users are advised to not fill Pots to such level where material comes in contact with the Top of the Oven.

In the event particles of material settle or collect inside of the oven slot of the Puck Base Unit. Use the included soft bristle cleaning brush lightly and gently to clean away the particles.

⚠ Avoid touching or interacting or removing the Internal Oven Gasket and Protecting Screen. Doing so will result in operational malfunction.

CERAMIC OVEN POTS

The Ceramic Oven Pots along with its stainless-steel screen bottom may be cleaned together. (Make sure to remove the gasket surrounding the Ceramic Oven Pot first. Also, make sure to remember to place this small gasket at a safe place remembering to place it back around the Ceramic Oven Pot for the Ceramic Oven Pot to be functional for use after cleaning in the Stem.

Failure to re-insert the silicone gasket around the ceramic pots after cleaning will result in no function from the Bowle.

Do not separate the stainless steel screen from the ceramic pot when cleaning.

THE STEM

Lay flat on its sides in a deep-dish Tupperware or, in a tumbler with the lower Ceramic Oven Pot housing of the Stem completely immersed inside the cleaning substance for up to 12 hours. Never unscrew or disassemble the base of the stem to clean.

THE MOUTHPIECE

The mouthpiece or silicone gaskets should not be placed in ISO. They can be soaked in warm water and washed with non-toxic dish cleaning detergent. It should be rinsed in warm water for at least 5 minutes to remove all traces of soap before drying for use.

CLEANING STEM, MOUTHPIECES, CERAMIC OVEN POTS, DRINKWARE, AND HERB SHREDDER

The Stem, Mouthpieces and Ceramic Oven Pots, should be cleaned when:

- There are visible large collections of particles or residue inside.

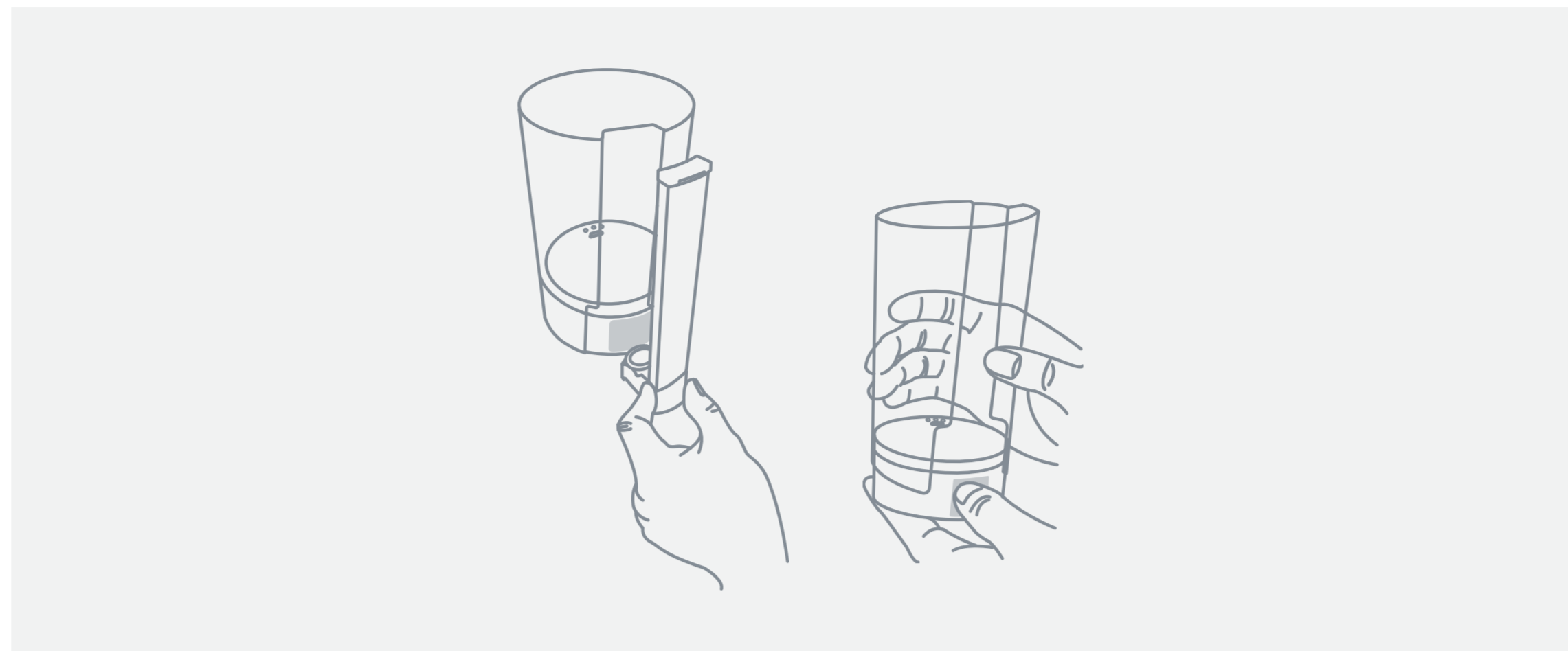

Before cleaning these accessories:

- Detach the Stem from the Puck Base Unit, also separate the Ceramic Oven Pot and Mouthpiece from the Stem.
- Separate the sealing gasket surrounding the Ceramic Oven Pot. The stainless steel screen in the ceramic oven pots do not need to be separated for cleaning. The Puck Base Unit and Charger should NOT be near the cleaning area.

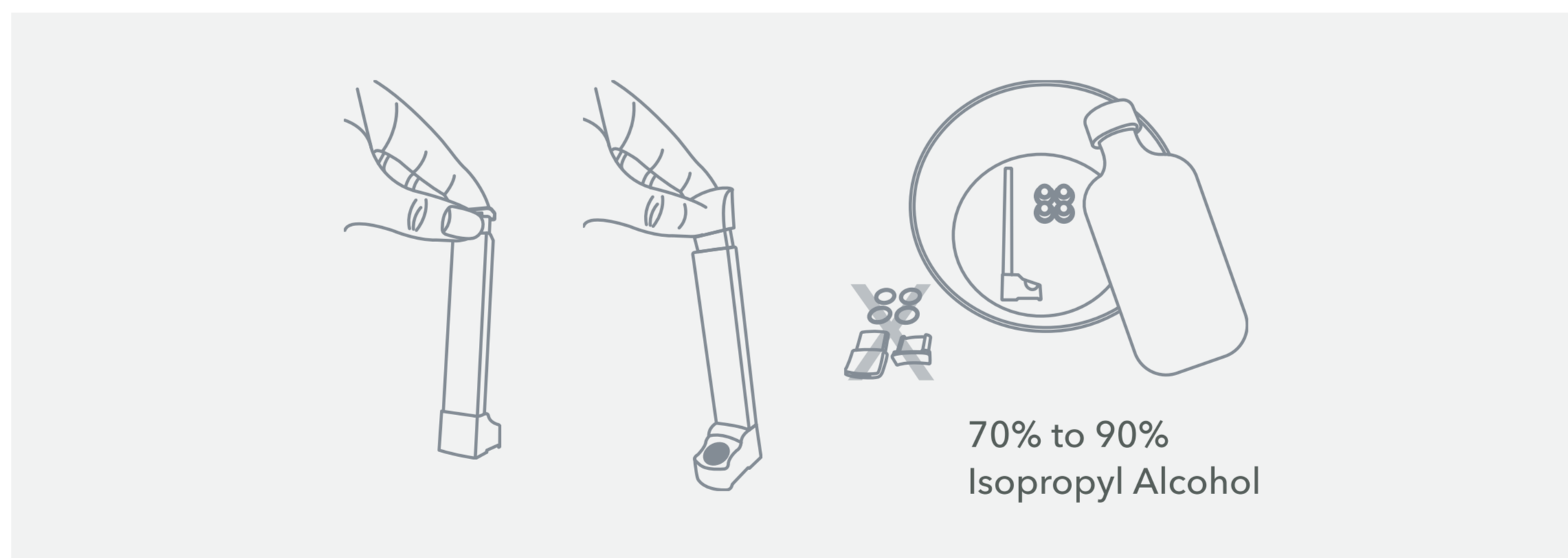

THE DRINKWARE

The Drinkware should be cleaned after each use. Tafée suggest rinsing in warm water and a soft cloth wash with a non-toxic dish washing detergent. After which the Drinkware should be cleaned dry with a clean microfiber cloth to prevent scratches and swirls. Alternatively, the Drinkware may be also cleaned in a Dishwasher (at the top section of your dishwasher). Tafée recommends hand wash. Never clean or soak Drinkware in isopropyl.

POTTER HERB SHREDDER

Potter Herb Shredder should be cleaned using the supplied maintenance kit when the corners of the shredder lodge particles that interfere with operation. The brush and the pick/stir tool may be used to dislodge accumulated particles over time and maintain the functionality of the shredder.

The cleaning time depends on the accumulated residue. Never clean or soak Potter+ acrylic versions in isopropyl or ethanol.

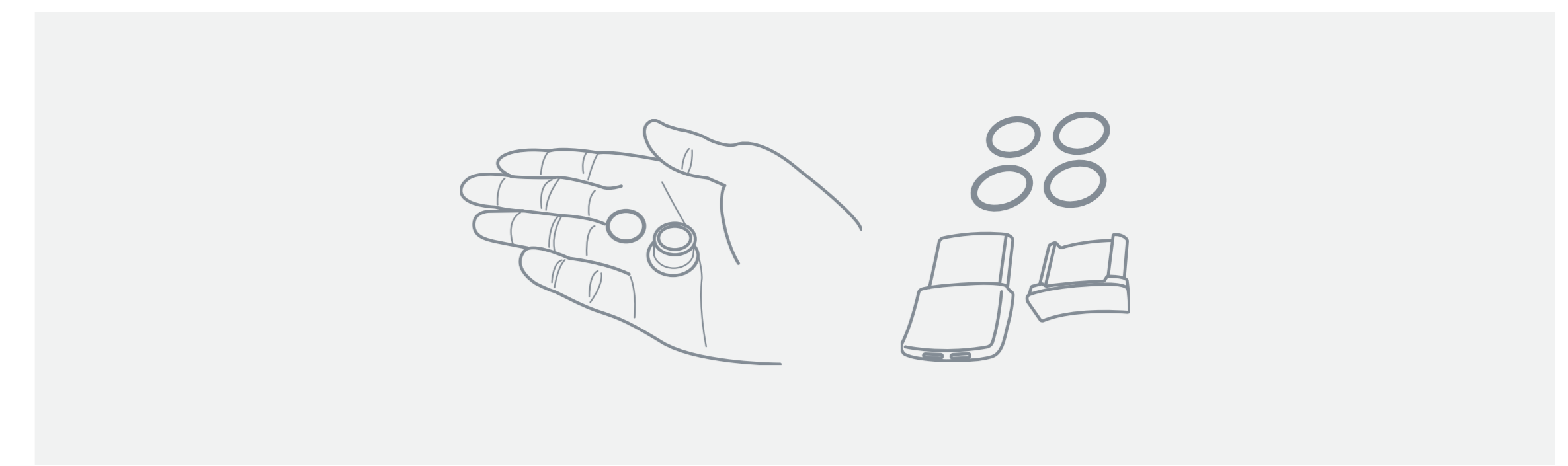

Use a soft tube brush, finger or cotton swabs to remove any internal residue.



For deep cleaning, immerse ONLY the following parts completely in Ethanol or Isopropyl alcohol for cleaning (Ceramic Pots and Stem Only). Afterwards they should be thoroughly rinsed in water possibly after also using a non-toxic pH balanced dish cleaning detergent.

Both the Ceramic Oven Pot and the Stem must be completely dried with a soft absorbent cloth internally and externally. The Stem may need to be shaken and blown with air a few times to dislodge water residue left internally after cleaning.

Never boil the accessories or immerse in hot water for a long time. High temperatures or lengthy exposure to cleaning agents may deform or discolor the accessories.

GOOD BATTERY HABITS

A few tips to get maximum use per charge and good battery habits.

- 1 Use the Press and Hold "Fire Button" operation method over the Press and Release method.
- 2 With the press and hold method, continue to inhale aerosol for a few seconds even after releasing the "Fire Button" as aerosol can still be produced even after the oven shuts down when the fire button is released. This increases efficiency of both material consumed and reduces battery life used per inhalation.
- 3 Charge Bowle after every second session and endeavor to avoid completely depleting your batteries.